

ANNEXURE - C

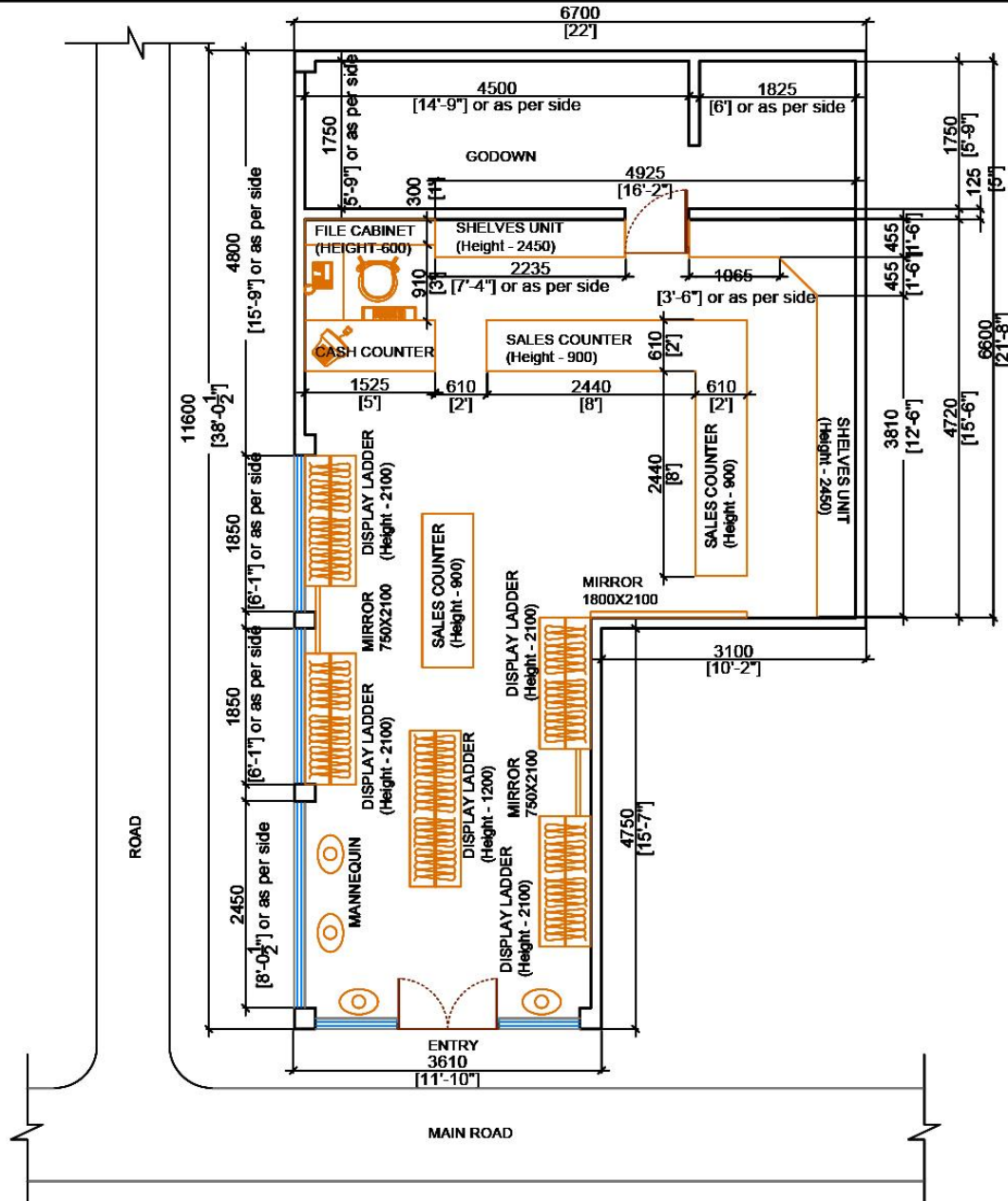

PROJECT:
 INTERIOR DECORATION WORKS OF TANTUJA SHOWROOM AT GROUND FLOOR AT KADAMTALA, DURGA BARI, WARD NO-6, HOLDING NO. 6/12/S/A & 6/D/12/F/A, JALPAIGURI MUNICIPALITY, JALPAIGURI.

ORGANIZATION:
 THE WEST BENGAL STATE HANDLOOM WEAVERS' CO-OPERATIVE SOCIETY LTD.
 TANTUJA BRAHMAN, BLOCK-DD, NO. 18/A, SALT LAKE, KOLKATA - 94



ELECTRICAL SUPERVISOR

S.A.E. (CIVIL)

MANAGER (CIVIL)

REVISIONS:

NO.	DATE	DESCRIPTION

SPECIFICATIONS:

PARTITION WALLS = 125 RTM THK. (Glass & otherwise mentioned)
 ALL EXTERNAL PLASTER 30 MM THK(3)
 ALL INTERNAL PLASTER 15 MM THK(2)
 ALL CEILING PLASTER 10 MM THK(2)
 FLOORING = TERRAZZO (1 P.2) / MARBLE / CERAMIC TILES
 ROOF = R.C.C. ROOF WITH WATER PROOFING MATERIALS
 R.C.C. WITH CEMENT, SAND AND STONE CHIPS (1:3:6), (1:1.5:3), (1:1:2)
 P.C.C. = PLAIN CEMENT CONCRETE WITH STONE CHIPS (1:3:6), (1:4:8)
 STEEL = Fe 80
 CONCRETE = M 10, M20, M25

DRAWING TITLE:
 FLOOR LAYOUT PLAN

Issue Date: 05-05-2025
 Drawn By: M.A. Checked By: P.S.
 FILE NO: 854 SCALE: 1:100
 DRAWING NO.:
 JALP / 854 / 1 / 01



REFERENCE 3D VIEW