

ANNEXURE - C

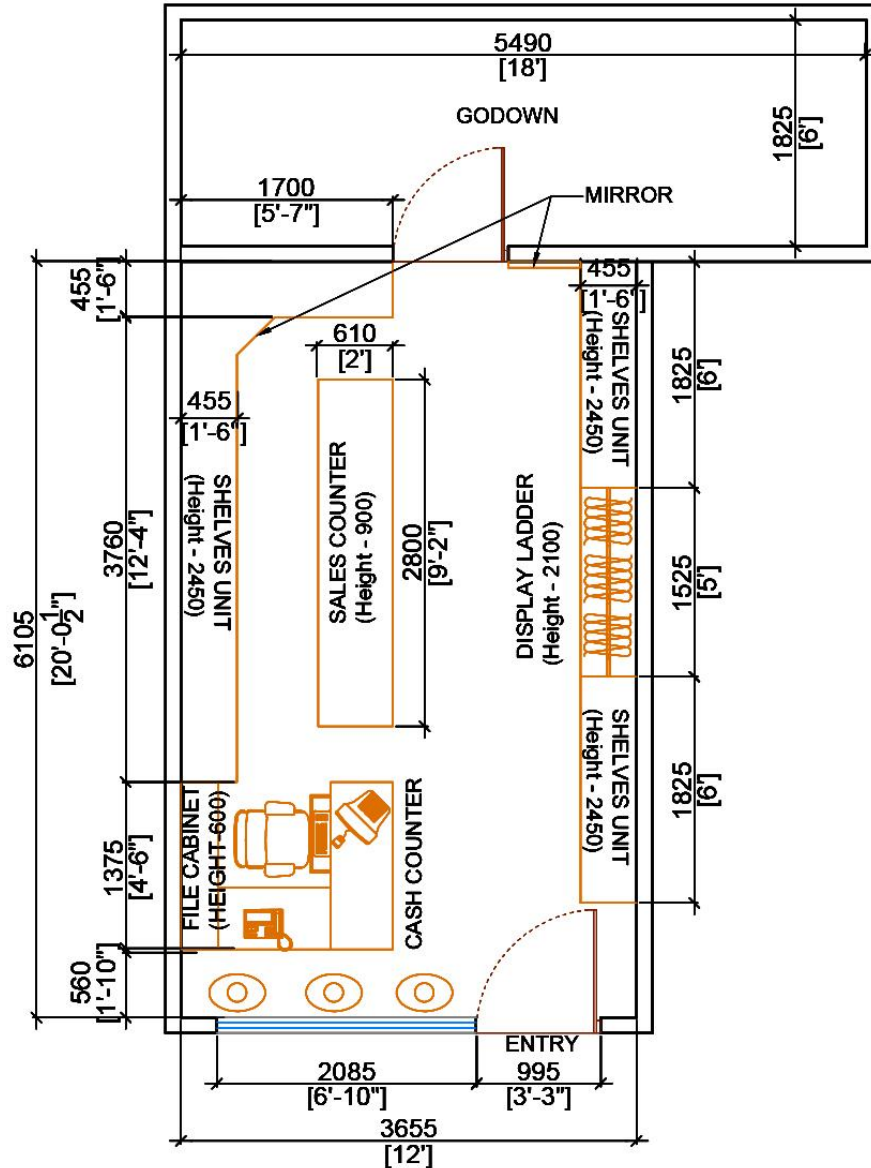

FLOOR LAYOUT PLAN

PROJECT:
 INTERIOR DECORATION WORKS OF TANTLUA
 SHOWROOM AT 17, PARK MARKET, HAIPUR,
 DHANBAD, JHARKHAND

ORGANIZATION:
 THE WEST BENGAL STATE HANDLOOM WEAVERS CO-OPERATIVE
 SOCIETY LTD.
 TANTLUA BHAVAN, BLOCK-DD, NO. 18 A, SALT LAKE, KOLKATA - 84



ELECTRICAL SUPERVISOR

S.A.E. (CIVIL)

MANAGER (CIVIL)

REVISIONS:

NO.	DATE	DESCRIPTION

SPECIFICATIONS:

PARTITION WALLS = 125 A75 S.M. THK. (Unless & otherwise mentioned)
 ALL EXTERNAL PLASTER 20 MM THK(1:3)
 ALL INTERNAL PLASTER 15 MM THK(1:3)
 ALL CEILING PLASTER 10 MM THK(1:4)
 FLOORING = TERRAZZO / P.S.P / MARBLES / CERAMIC TILES
 ROOF = R.C.C. ROOF WITH WATER PROOFING MATERIALS
 R.C.C. = HYTH CEMENT, SAND AND STONE CHIPS (1:2:4), (1:1.5:3), (1:1.5:2)
 P.C.C. = PLAIN CEMENT CONCRETE WITH STONE CHIPS (1:2:8), (1:4:8)
 STEEL = Fe 500
 CONCRETE = M15, M20, M25

DRAWING TITLE:
 FLOOR LAYOUT PLAN

Issue Date: 07-05-2025
 Design By: S.A.E. (CIVIL) Checked By: Manager (CIVIL)
 PROJECT No: 2025 SCALE: 1:50
 DRAWING No.:
 DWN / 2025 / 01



REFERENCE 3D VIEW