

ANNEXURE - C

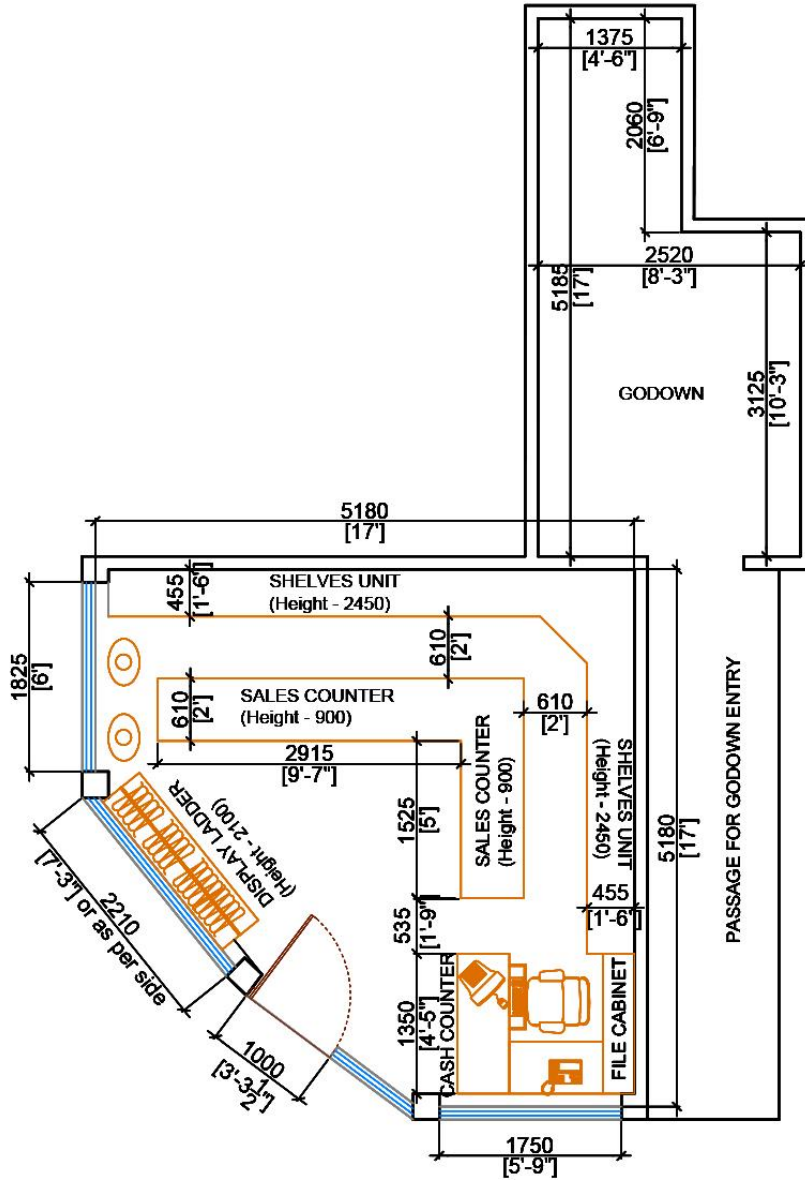

FLOOR LAYOUT PLAN

PROJECT :

INTERIOR DECORATION WORKS OF TANTUJA SHOWROOM AT BARASAT COLONY MORE, P.O- BARASAT, KOLKATA 700124

ORGANIZATION :

THE WEST BENGAL STATE HANDLOOM WEAVERS' CO-OPERATIVE SOCIETY LTD.
TANTUJA BHAVAN, BLOCK-DD, NO. 18/A, SALT LAKE, KOLKATA - 84



ELECTRICAL SUPERVISOR

S.A.E. (CIVIL)

MANAGER (CIVIL)

REVISIONS:

NO.	DATE	DESCRIPTION

SPECIFICATIONS :

PARTITION WALLS - 125 MM THK. (Unless & otherwise mentioned)
ALL EXTERNAL PLASTER 20 MM THK(1:3)
ALL INTERNAL PLASTER 16 MM THK(1:3)
ALL CEILING PLASTER 10 MM THK(1:3)
FLOORING = TERRAZZO (1:2) / MARBLE / CERAMIC TILES
ROOF = R.C.C. ROOF WITH WATER PROOFING MATERIALS
R.C.C. = WITH CEMENT: SAND AND STONE CHIPS (1:2&4) (1:1.5), (1:1.5)
R.C.C. = PLAIN CEMENT CONCRETE WITH STONE CHIPS (1:3&6), (1:4&8)
STEEL = Fe 80
CONCRETE = M15, M20, M25

DRAWING TITLE :

FLOOR LAYOUT PLAN

Issue Date: 07-05-2025

Design By: S.A.E.(CIVIL)

Checked by: Manager (CIVIL)

FILE No: 4791

SCALE: 1:50

DRAWING No.:

BARASAT / 4791 / 01



REFERENCE 3D VIEW